



VIZI BEAM RX2

User Manual

©2024 ADJ Products, LLC all rights reserved. Information, specifications, diagrams, images, and instructions herein are subject to change without notice. ADJ Products, LLC logo and identifying product names and numbers herein are trademarks of ADJ Products, LLC. Copyright protection claimed includes all forms and matters of copyrightable materials and information now allowed by statutory or judicial law or hereinafter granted. Product names used in this document may be trademarks or registered trademarks of their respective companies and are hereby acknowledged. All non-ADJ Products, LLC brands and product names are trademarks or registered trademarks of their respective companies.

ADJ Products, LLC and all affiliated companies hereby disclaim any and all liabilities for property, equipment, building, and electrical damages, injuries to any persons, and direct or indirect economic loss associated with the use or reliance of any information contained within this document, and/or as a result of the improper, unsafe, insufficient and negligent assembly, installation, rigging, and operation of this product.

Europe Energy Saving Notice
Energy Saving Matters (EuP 2009/125/EC)
Saving electric energy is a key to help protecting the environment. Please turn off all electrical products when they are not in use. To avoid power consumption in idle mode, disconnect all electrical equipment from power when not in use. Thank you!

DOCUMENT VERSION



Due to additional product features and/or enhancements, an updated version of this document may be available online.
Please check www.adj.com for the latest revision/update of this manual before beginning installation and/or programming.

Date	Document Version	Software Version	DMX Channels	Notes
04/24/2024	1.0	0.0.1	16 / 20 Ch	Initial release
07/29/2024	1.1	N/C	No Change	Updated Gobos

CONTENTS

Introduction	4
Limited Warranty (USA Only)	5
Warranty Registration Features FCC	6
Safety Precautions	7
Overview	9
Lamp Warnings	10
Lamp Replacement	12
Color and Gobos	13
Installation	14
Remote Device Management (RDM)	18
Control Panel	19
System Menu	20
DMX Set Up	23
DMX Traits	25
Primary-Secondary Set Up Multi Unit Power Linking	31
Maintenance Guidelines	32
Error Codes	33
Dimensional Drawings	34
Specifications	35

INTRODUCTION

Unpacking: Thank you for purchasing the Vizi Beam RX2 by ADJ Products, LLC. Every device has been thoroughly tested and has been shipped in perfect operating condition. Carefully check the shipping carton for damage that may have occurred during shipping. If the carton appears to have been damaged, carefully inspect your fixture for any damage and be sure all accessories necessary to operate the unit have arrived intact. In the event that damage has been found or parts are missing, please contact our toll free customer support number for further instructions. Do not return this unit to your dealer without first contacting customer support.

Introduction: The ADJ Lighting Vizi Beam RX2 is a compact, high-performance moving head beam fixture that features a 100W Osram Sirius HRI discharge lamp, a razor-sharp 2-degree beam, two prism effects, and a host of high-performance features for the modern lighting professional. **This product is intended to be used by professionally trained personnel only and is not suitable for private use.**

Customer Support: Contact ADJ Service for any product related service and support needs. Also visit forums.adj.com with questions, comments or suggestions.

Parts: To purchase parts online visit:

<http://parts.adj.com> (US)

<http://www.adjparts.eu> (EU)

ADJ SERVICE USA - Monday - Friday 8:00am to 4:30pm PST

Voice: 800-322-6337 | Fax: 323-582-2941 | support@adj.com

ADJ SERVICE EUROPE - Monday - Friday 08:30 to 17:00 CET

Voice: +31 45 546 85 60 | Fax: +31 45 546 85 96 | support@adj.eu

ADJ PRODUCTS LLC USA

6122 S. Eastern Ave. Los Angeles, CA. 90040

323-582-2650 | Fax 323-532-2941 | www.adj.com | info@adj.com

ADJ SUPPLY Europe B.V

Junostraat 2 6468 EW Kerkrade, The Netherlands

+31 (0)45 546 85 00 | Fax +31 45 546 85 99

www.adj.eu | info@adj.eu

ADJ PRODUCTS GROUP Mexico

AV Santa Ana 30 Parque Industrial Lerma, Lerma, Mexico 52000

+52 (728) 282-7070

For software updates, please contact ADJ service!

Warning! This unit is intended for indoor use only! Do not expose to rain or moisture!

CAUTION! There are no user serviceable parts inside this unit. Do not attempt any repairs yourself, as doing so will void your manufacturer's warranty. In the unlikely event your unit may require service, please contact ADJ Products, LLC.

Do not discard the shipping carton in the trash. Please recycle when ever possible.

LIMITED WARRANTY (USA ONLY)

- A. ADJ Products, LLC hereby warrants, to the original purchaser, ADJ Products, LLC products to be free of manufacturing defects in material and workmanship for a prescribed period from the date of purchase (see specific warranty period on reverse). This warranty shall be valid only if the product is purchased within the United States of America, including possessions and territories. It is the owner's responsibility to establish the date and place of purchase by acceptable evidence, at the time service is sought.
- B. For warranty service, you must obtain a Return Authorization number (RA#) before sending the product back—please contact ADJ Products, LLC Service Department at 800-322-6337. Send the product only to the ADJ Products, LLC factory. All shipping charges must be prepaid. If the requested repairs or service (including parts replacement) are within the terms of this warranty, ADJ Products, LLC will pay return shipping charges only to a designated point within the United States. If the entire instrument is sent, it must be shipped in its original package and packaging material. No accessories should be shipped with the product. If any accessories are shipped with the product, ADJ Products, LLC shall incur no liability whatsoever for loss of or damage to any such accessories, nor for the safe return thereof.
- C. This warranty is void if the product serial number and/or labels are altered or removed; if the product is modified in any manner which ADJ Products, LLC concludes, after inspection, affects the reliability of the product; if the product has been repaired or serviced by anyone other than the ADJ Products, LLC factory unless prior written authorization was issued to purchaser by ADJ Products, LLC; if the product is damaged because it was not properly maintained as set forth in the product instructions, guidelines and/or user manual.
- D. This is not a service contract, and this warranty does not include maintenance, cleaning, or periodic check-up. During the period specified above, ADJ Products, LLC will replace defective parts at its expense with new or refurbished parts, and will absorb all expenses for warranty service and repair labor by reason of defects in material or workmanship. The sole responsibility of ADJ Products, LLC under this warranty shall be limited to the repair of the product, or replacement thereof, including parts, at the sole discretion of ADJ Products, LLC. All products covered by this warranty were manufactured after August 15, 2012, and bear identifying marks to that effect.
- E. ADJ Products, LLC reserves the right to make changes in design and/or improvements upon its products without any obligation to include these changes in any products theretofore manufactured.
- F. No warranty, whether expressed or implied, is given or made with respect to any accessory supplied with products described above. Except to the extent prohibited by applicable law, all implied warranties made by ADJ Products, LLC in connection with this product, including warranties of merchantability or fitness, are limited in duration to the warranty period set forth above. And all warranties, whether expressed or implied, including warranties of merchantability or fitness, are limited in duration to the warranty period set forth above. The consumer's and/or dealer's sole remedy shall be such repair or replacement as is expressly provided above; and under no circumstances shall ADJ Product, LLC be liable for any loss and/or damage, direct and/or consequential arising out of the use of, and/or inability to use this product.
- G. This warranty is the only written warranty applicable to ADJ Products, LLC products, and supersedes all prior warranties and written descriptions of warranty terms and conditions heretofore published.

MANUFACTURER'S LIMITED WARRANTY PERIODS:

- Non-LED Lighting Products = 1-Year (365 Days) (Including Special Effect Lighting, Intelligent Lighting, UV lighting, Strobos, Fog Machines, Bubble Machines, Mirror Balls, Par Cans, Trussing, Lighting Stands, Power/Data Distribution, etc. excluding LED and lamps)
- Laser Products = 1-Year (365 Days) (excluding laser diodes which have a 6-Month Limited Warranty)
- LED Products = 2-Year (730 Days) (excluding batteries which have a 180 Day Limited Warranty)
- NOTE: 2-Year (730 Days) Limited Warranty ONLY applies to product purchased within the United States. StarTec Series = 1-Year (365 Days) (excluding batteries which have a 180 Day Limited Warranty)
- ADJ DMX Controllers = 2 Year (730 Days)
- American Audio Products = 1 Year (365 Days)

WARRANTY REGISTRATION

Please fill out the enclosed warranty card to validate your purchase. All returned service items, whether under warranty or not, must be freight pre-paid and accompanied by a return authorization (R.A.) number. The R.A. number must be clearly written on the outside of the return package. A brief description of the problem as well as the R.A. number must also be written down on a piece of paper included in the shipping carton. If the unit is under warranty, you must provide a copy of your proof of purchase invoice. You may obtain an R.A. number by contacting our customer support team. All packages returned to the service department not displaying an R.A. number on the outside of the package will be returned to the shipper.

FEATURES

- On-Board Wireless DMX
- Motorized Focus + 16-bit fine focus
- 2-degree beam angle
- Frost Filter to create wash effect
- High quality glass lens
- 2 Rotating prisms
- 0-100% smooth dimming
- Various strobe speeds
- OTA, wireless, firmware updates
- Fan cooled

INCLUDED ITEMS

- Omega Brackets (x2)
- Outdoor Locking Power Cord (x1)

FCC STATEMENT

This device complies with Part 15 of the FCC Rules. Operation is subject to the following two conditions (1) this device may not cause harmful interference, and (2) this device must accept any interference received, including interference that may cause undesired operation.

FCC RADIO FREQUENCY INTERFERENCE WARNINGS & INSTRUCTIONS

NOTE: This equipment has been tested and found to comply with the limits for a Class A digital device, pursuant to part 15 of the FCC Rules. These limits are designed to provide reasonable protection against harmful interference when the equipment is operated in a commercial environment. This equipment generates, uses, and can radiate radio frequency energy and, if not installed and used in accordance with the instruction manual, may cause harmful interference to radio communications. Operation of this equipment in a residential area is likely to cause harmful interference in which case the user will be required to correct the interference at his own expense.

Energy Saving Matters (EuP 2009/125/EC)

Saving electric energy is a key to help protecting the environment. Please turn off all electrical products when they are not in use. To avoid power consumption in idle mode, disconnect all electrical equipment from power when not in use. Thank you!



SAFETY PRECAUTIONS



**HIGH
INTENSITY
ULTRAVIOLET
LIGHT**

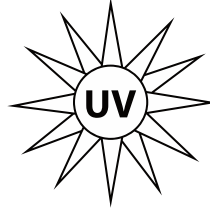

**AVOID DIRECT EYE & SKIN EXPOSURE.
WEAR PROPER EYE & SKIN PROTECTION.
SEE MANUAL FOR SAFETY INSTRUCTIONS.**

RISK GROUP 3 - RISK OF EXPOSURE TO ULTRAVIOLET UV RADIATION!

FIXTURE EMITS HIGH INTENSITY WAVELENGTH OF ULTRAVIOLET UV LIGHT FROM THE UV COLOR FILTER.

WEAR PROPER EYE AND SKIN PROTECTION. AVOID PROLONGED PERIODS OF EXPOSURE TO UV COLOR FILTER.

AVOID WEARING WHITE COLOR CLOTHING AND/OR USING UV PAINTS ON SKIN. AVOID DIRECT EYE AND/OR SKIN EXPOSURE AT DISTANCES LESS THAN 11 feet (3.3m).

DO NOT OPERATE FIXTURE WITH DAMAGED/MISSING EXTERNAL COVERS.

DO NOT LOOK DIRECTLY INTO THE UV LIGHT AND/OR VIEW UV LIGHT DIRECTLY WITH OPTICAL INSTRUMENTS THAT MAY CONCENTRATE THE LIGHT/RADIATION OUTPUT.

INDIVIDUALS SUFFERING FROM A RANGE OF EYE CONDITIONS, SUNLIGHT EXPOSURE DISORDERS, OR INDIVIDUALS USING PHOTSENSITIVE MEDICATION, MAY EXPERIENCE DISCOMFORT IF EXPOSED TO THE ULTRAVIOLET UV LIGHT EMITTED FROM THE UV LED.

SAFETY PRECAUTIONS



PROTECTION CLASS 1 - FIXTURE MUST BE PROPERLY GROUNDED.



THERE ARE NO USER SERVICEABLE PARTS INSIDE THIS UNIT. DO NOT ATTEMPT ANY REPAIRS YOURSELF, AS DOING SO WILL VOID YOUR MANUFACTURER'S WARRANTY. DAMAGES RESULTING FROM MODIFICATIONS TO THIS FIXTURE AND/OR THE DISREGARD OF SAFETY INSTRUCTIONS AND GUIDELINES IN THIS MANUAL VOID THE MANUFACTURER'S WARRANTY AND ARE NOT SUBJECT TO ANY WARRANTY CLAIMS AND/OR REPAIRS.



**NEVER LOOK DIRECTLY INTO THE LIGHT SOURCE!
RETINA INJURY RISK - MAY INDUCE BLINDNESS!
SENSITIVE PERSONS MAY SUFFER AN EPILEPTIC SHOCK!**

- ***Ambient operating temperature is 32°F to 104°F (0°C to 40°C)!***
- DO NOT TOUCH the fixture housing during operation. Disconnect the power and allow approximately 15 minutes for the fixture to cool down before servicing.
- DO NOT shake the fixture, and avoid brute force when installing and/or operating the fixture.
- DO NOT operate the fixture if the power cord has become frayed, crimped and/or damaged. If the power cord is damaged, replace immediately with a new one of the same power rating.
- DO NOT attempt to remove or break off the ground prong from the electrical cord. This prong is used to reduce the risk of electrical shock and fire in case of an internal short.
- DO NOT attempt to operate this unit if it has been damaged in any way.
- Disconnect from main power before making any type of connection.
- DO NOT block any air ventilation slots. All fan and air inlets must remain clean and never blocked. Allow approx. 6" (15cm) between fixture and other devices or a wall for proper cooling.
- Always be sure to mount this unit in an area that will allow proper ventilation. Allow about 6" (15cm) between this device and a wall.
- This device is intended for indoor use only! Outdoors usage voids all manufacturer's warranties.
- DO NOT remove the cover for any reason.
- When installing fixture in a suspended environment, always use mounting hardware that is no less than M10 x 25mm, and always install fixture with an appropriately rated safety cable.
- Never plug this unit in to a dimmer pack.
- During long periods of non-use, disconnect the unit's main power.
- Always mount this unit in safe and stable matter.
- Power-supply cords should be routed so that they are not likely to be walked on or pinched by items placed upon or against them, paying particular attention to the point where they exit from the unit.
- Cleaning - The fixture should be cleaned only as recommended by the manufacturer.
- Heat - The appliance should be situated away from heat sources such as radiators, heat registers, stoves, or other appliances (including amplifiers) that produce heat.
- The fixture should be serviced by qualified service personnel when:
 - A. The power-supply cord or the plug have been damaged.
 - B. Objects have fallen onto, or liquids have been spilled into, the fixture.
 - C. The fixture does not appear to operate normally or exhibits a marked change in performance.
 - D. The fixture has fallen and/or has been subjected to extreme handling.

OVERVIEW

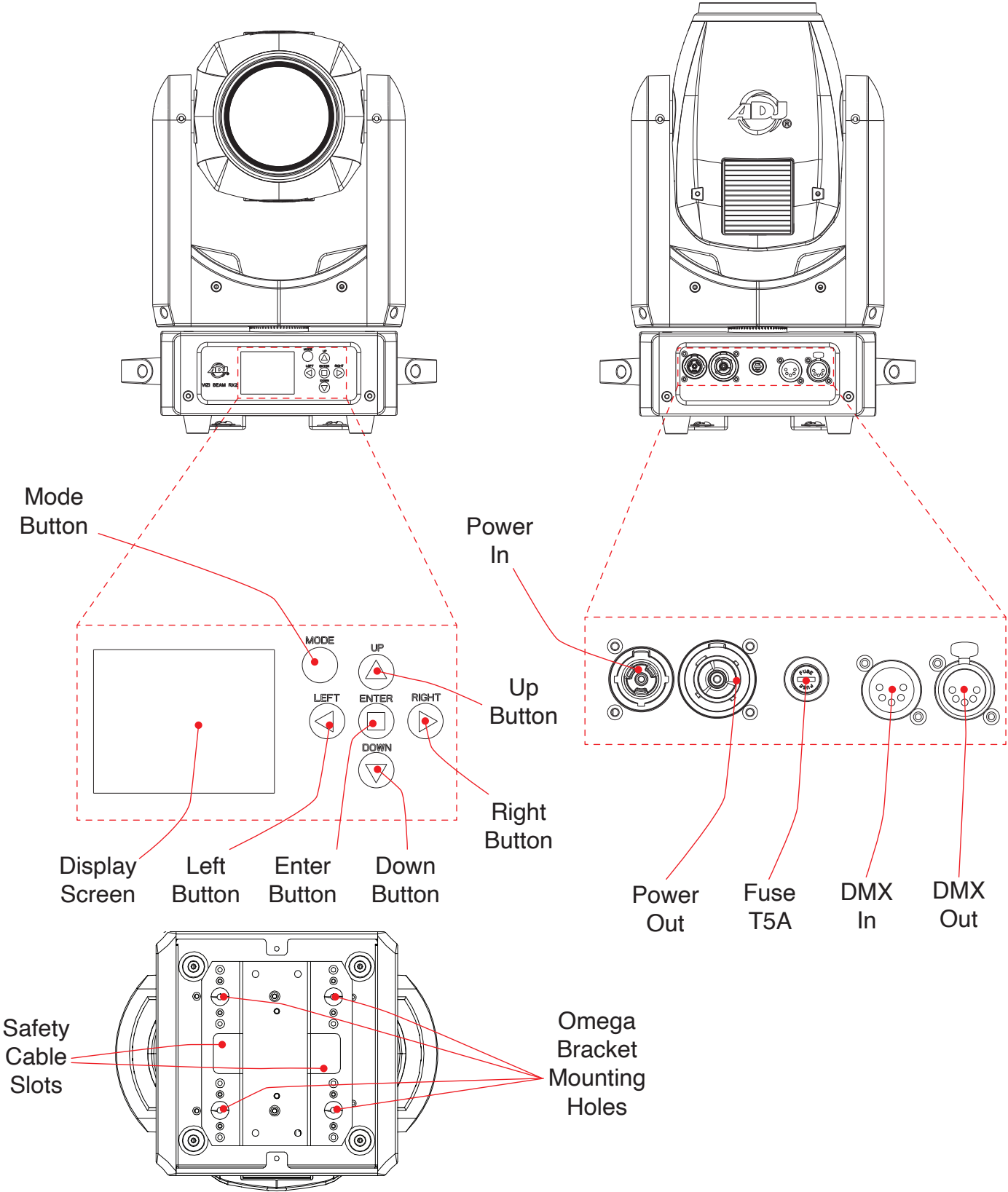

LAMP WARNINGS

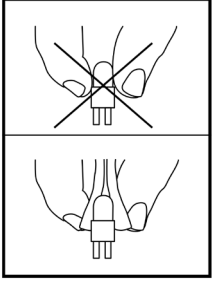

This fixture is fitted with a discharge lamp which is highly susceptible to damage if improperly handled. **NEVER** touch the lamp with your bare fingers, as the oil from your hands will shorten lamp life. Also, never move the fixture until the lamps have had ample time to cool. Avoid switching the fixture ON and OFF repeatedly in short intervals, as this will reduce lamp life and intensity. To achieve the intensity associated with discharge lamps, these lamps use gas sealed in a high-pressure environment to emit a brilliant output.

Due to the high pressure involved with the construction of the lamp, ***IT MAY EXPLODE DURING PROLONGED EXTENSIVE USE.*** This risk is increased with age; added care is encouraged when dealing with older lamps. Thus, the lamp must always be replaced at the end of their recommended duty cycle. Extreme caution should be used when operating this or any fixture fitted with a gas discharge lamp.

UV RADIATION NOTICE



THIS FIXTURE EMITS INTENSE UV RADIATION, WHICH IS HARMFUL TO THE EYES AND SKIN. THE INTENSE LUMINESCENCE OF THE LAMP CAN CAUSE SEVERE DAMAGE TO THE RETINA. NEVER OPERATE THIS FIXTURE WITH ANY OF THE PROTECTIVE COVERS REMOVED. THESE COVERS HAVE BEEN SPECIALLY DESIGNED TO SHIELD AGAINST UV RADIATION.

LAMP REPLACEMENT



USE ONLY GENUINE ORIGINAL OSRAM™ LAMPS. OTHER BRAND LAMPS WILL CAUSE DAMAGE AND WILL VOID FIXTURE WARRANTY!



DISCONNECT THE MAIN POWER SUPPLY BEFORE REPLACING LAMP! FIXTURE MUST COOL FOR 15 minutes BEFORE REPLACING LAMP! NEVER TOUCH LAMP WITH BARE HANDS, ALWAYS WEAR GLOVES! OIL FROM HANDS WILL SHORTEN LIFE OF LAMP!



MAKE SURE ALL COVERS/FIXTURES ARE REPLACED/SECURED BEFORE OPERATING FIXTURE TO PREVENT ANY RISK AND/OR DAMAGE TO EYE RETINA FROM UV RADIATION EXPOSURE!

LAMP WARNINGS

LAMP REPLACEMENT WARNING:

This is for your safety and the life length of the unit. The Osram® Sirius HRI Discharge lamp has lifetime of 6000 hours.

ADJ recommends periodically checking the lamp running time (see the “Lamp Time” sub-section of the **System Menu** section of this manual). When the lamp approaches or reaches the 6000 hour mark, the lamp should be removed and replaced with a fresh unit.

Replace the lamp following the instructions shown in the **Lamp Replacement** section of this manual. After replacing the lamp you must clear the LAMP TIME (see the “Lamp Time” sub-section of the **System Menu** section of this manual).

Warning: DO NOT use this lamp for more than 6000 hours. Using the lamp any longer than the set life could seriously damage your unit.

WARNING! CAUTION! FIRE HAZARD! DUE TO THE EXTREME HEAT CAUSED BY THIS LAMP, THE MINIMUM DISTANCE TO LIGHTED OBJECTS IS 12 METERS (39.5FT).

LAMP REPLACEMENT

Follow the steps below to replace the Osram Sirius HRI discharge lamp.

1. Power down the fixture and disconnect from the power source. Allow at least 15 minutes for the fixture to cool, and make sure all components are cool enough to handle before beginning this procedure. Loosen the four (4) screws on each half of the head casing, and remove both halves of the casing.

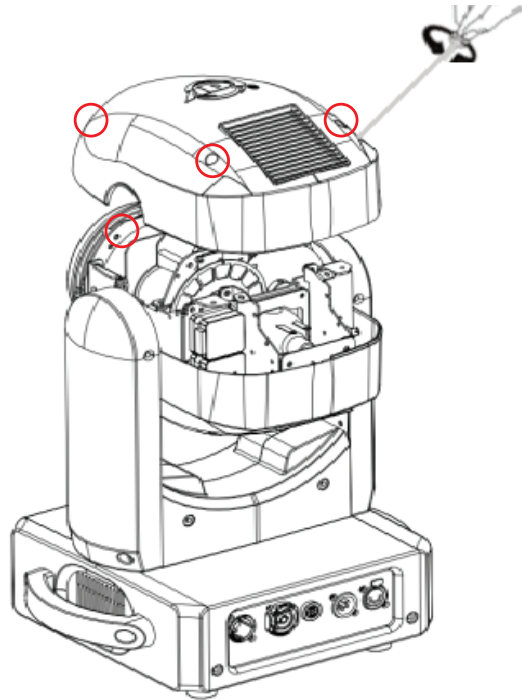

2. Loosen the two (2) screws on the lamp protector plate located directly behind the lamp, then remove the protector plate.
3. Loosen the four (4) screws on the lamp fixing plate, then remove the plate. Remove the lamp from its socket, disconnect the lamp, and replace with a fresh unit. Re-assemble the unit by reversing these steps.

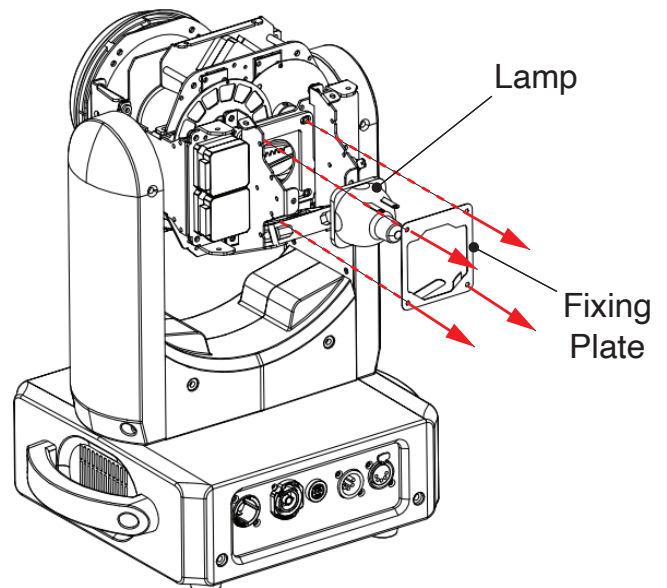
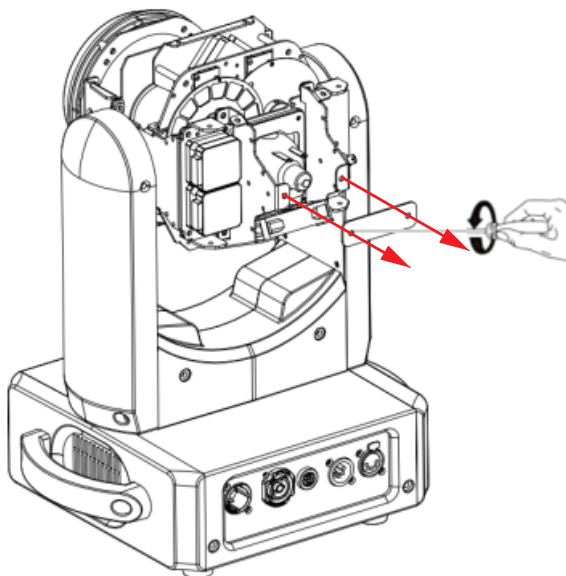

COLORS AND GOBOS

COLORS



Position 1
Red



Position 2
Blue



Position 3
Green



Position 4
Lime



Position 5
Orange



Position 6
Pink



Position 7
Lavender



Position 8
Medium Red



Position 9
Aqua



Position 10
Amber



Position 11
CTB 9000K



Position 12
4500K



Position 13
CTO 3200K



Position 14
UV

GOBOS

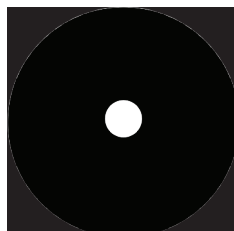

Gobo 1

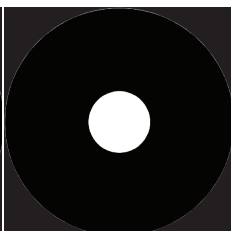

Gobo 2

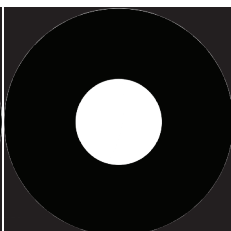

Gobo 3



Gobo 4



Gobo 5



Gobo 6



Gobo 7



Gobo 8



Gobo 9

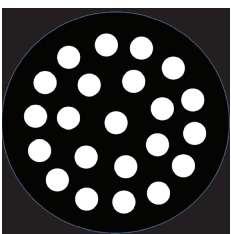

Gobo 10



Gobo 11



Gobo 12



Gobo 13

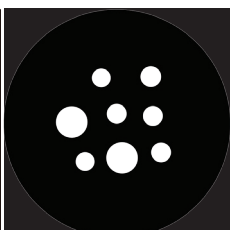

Gobo 14



Gobo 15

INSTALLATION



DO NOT INSTALL THE FIXTURE IF YOU ARE NOT QUALIFIED TO DO SO!

Fixture **MUST** be installed following all local, national, and country commercial electrical and construction codes and regulations.

When installing the unit, the trussing or area of installation must be able to hold 10 times the weight of the unit and any attached accessories without any deformation. The unit must be secured with a secondary safety attachment, e.g. an appropriately-rated safety cable.

Before rigging/mounting a single fixture to any metal truss/structure or placing the fixture(s) on any surface, a professional equipment installer **MUST** be consulted to determine if the metal truss/structure or surface is properly certified to safely hold the combined weight of the fixture(s), clamps, cables, and accessories.

Ambient operating temperature is range **-32°F to 104°F (0°C to 40°C)**. Do not operate this device when ambient temperature falls outside of this range.

Fixture(s) should be installed away from walking paths, seating areas, or areas where unauthorized personnel might reach the fixture by hand.

NEVER stand directly below the fixture(s) when rigging, removing, or servicing.

Overhead fixture installation must always be secured with a secondary safety attachment, such as an appropriately rated safety cable that can hold 10 times the weight of the fixture.

Overhead mounting requires extensive experience, including calculating working load limits, knowledge of installation material being used, and periodic safety inspection of all installation material as well as the unit itself. If you lack these qualifications, do not attempt the installation yourself.

The installation should be checked by a skilled person once a year.

INSTALLATION

CLAMP MOUNTING

This fixture features mounting holes on the underside for the attachment of Omega clamps. When mounting the fixture to a truss or any other suspended structure, be sure to secure an appropriate rated clamp (not included) to each Omega bracket. Insert a bolt of appropriate size through the bottom of the mounting clamp and the central hole on the mounting bracket, and secure them together with a matching nut. Then insert the twist lock fasteners of the Omega bracket into the mounting holes on the fixture, and twist to secure in place. ***Please note that two mounting clamps and two Omega brackets are required to securely install this unit.*** Additionally, a safety cable of the appropriate weight rating should be secured to at least one of the two available locations on the underside of the fixture base.

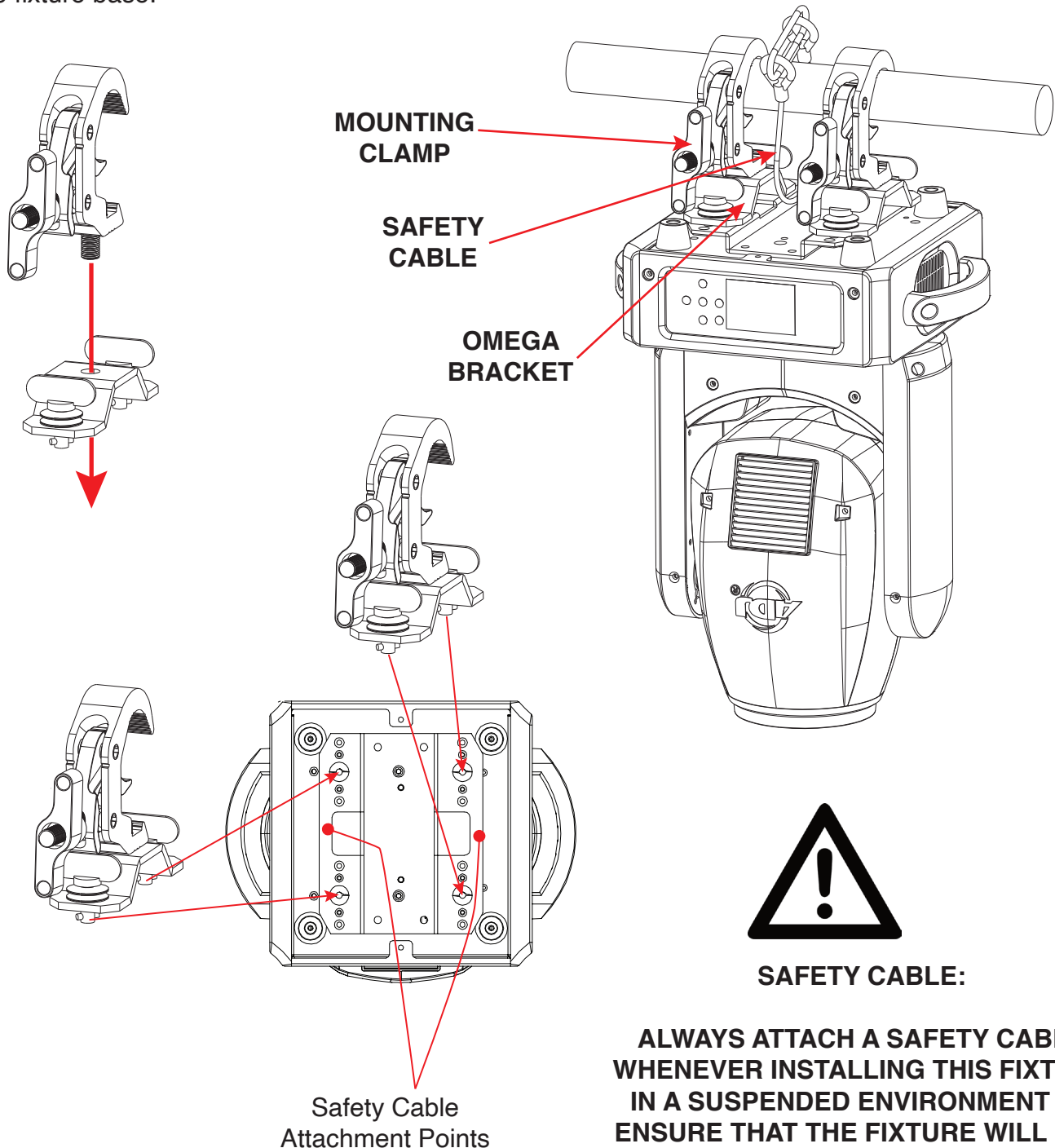

SAFETY CABLE:

**ALWAYS ATTACH A SAFETY CABLE
WHENEVER INSTALLING THIS FIXTURE
IN A SUSPENDED ENVIRONMENT TO
ENSURE THAT THE FIXTURE WILL NOT
FALL IF THE CLAMP FAILS.**

INSTALLATION

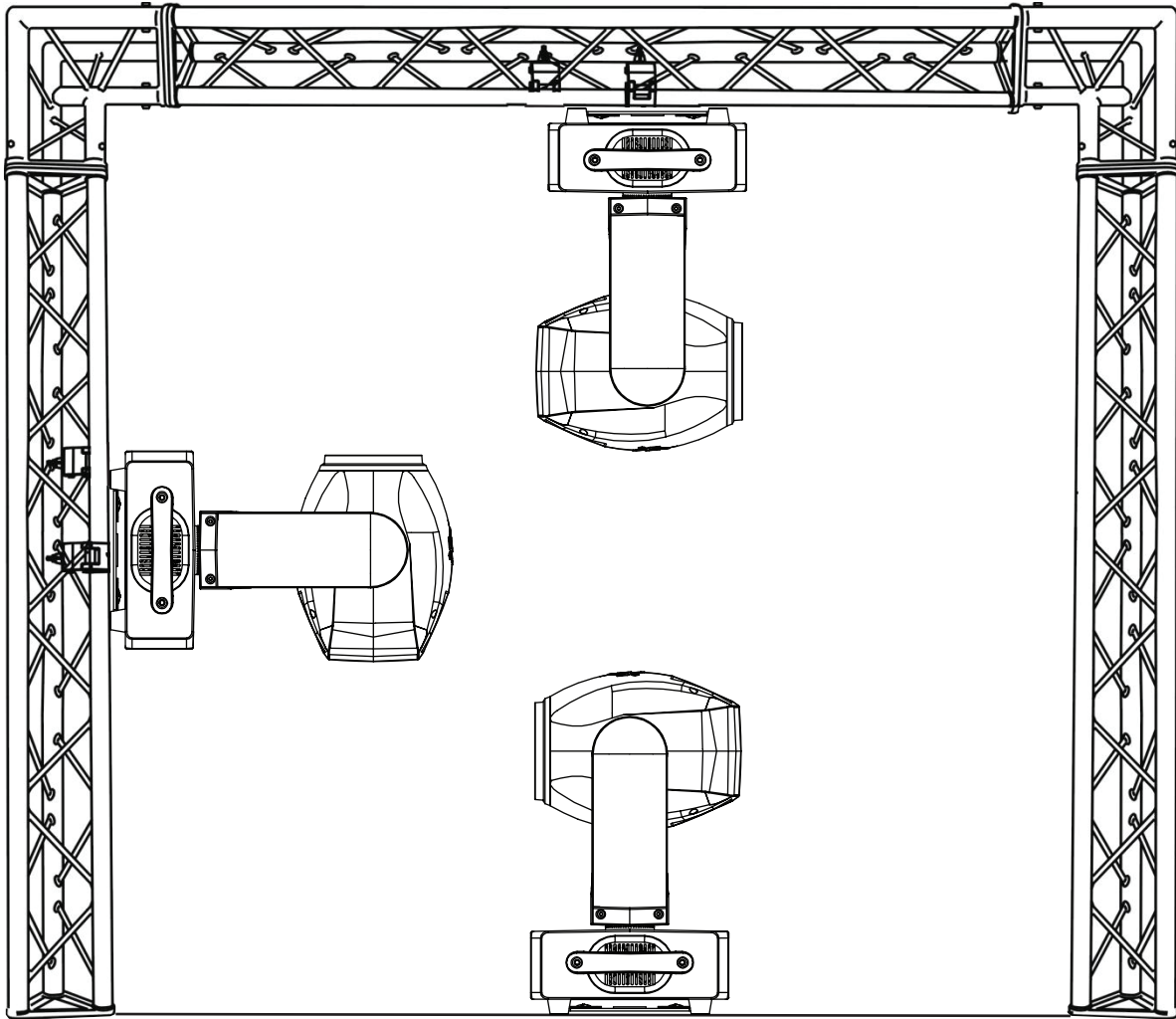

The unit is fully operational in three different mounting positions: hanging upside-down from the ceiling or trussing, sideways on trussing, or set on a flat level surface. Be sure this fixture is kept at least 12m (40ft) away from any flammable materials (decorations, etc). Always use and install a safety cable (not included) as a safety measure to prevent accidental damage and/or injury in the event the clamp fails. Never use the carrying handles for secondary attachment.



FALLING FIXTURES CAN CAUSE SEVERE INJURY OR SERIOUS EQUIPMENT DAMAGE! FOR THIS REASON, FIXTURES SHOULD BE INSTALLED AND INSPECTED ONLY BY QUALIFIED PERSONNEL. DO NOT INSTALL THE UNIT IF YOU LACK THE QUALIFICATIONS TO DO SO, OR IF YOU HAVE DOUBTS ABOUT THE SAFETY AND SECURITY OF THE INSTALLATION SETUP OR LOCATION!



ALWAYS ATTACH A SAFETY CABLE WHENEVER INSTALLING THIS FIXTURE IN A SUSPENDED ENVIRONMENT TO ENSURE THAT THE FIXTURE WILL NOT FALL IF THE CLAMP FAILS.

INSTALLATION

POTENTIAL INTERNAL FIXTURE DAMAGE FROM EXTERNAL SOURCES OF LIGHT BEAMS

External sources of light beams from direct sunlight, lighting moving head fixtures, and lasers, which are focused directly towards the exterior housing and/or penetrate the front lens opening of ADJ lighting fixtures, can cause severe internal damage including burning to optics, dichroic color filters, glass and metal gobos, prisms, animation wheels, frost filters, iris, shutters, motors, belts, wiring, discharge lamps, and LEDs.

This issue is not specific only to ADJ lighting fixtures, it is a common issue with lighting fixtures from all manufacturers. Although there is no true way to fully prevent this issue from happening, the guidelines below can prevent any potential damage from occurring if followed. Contact ADJ Service for more details.

DO NOT EXPOSE THE FIXTURE AND/OR FRONT LENS OPENING TO LIGHT BEAMS FROM DIRECT SUNLIGHT, OTHER LIGHTING MOVING HEAD FIXTURES, AND LASERS WHILE UNPACKING, INSTALLATION, USE, AND EXTENDED IDLE TIMES OUTDOORS. DO NOT FOCUS A LIGHT BEAM FROM ONE LIGHTING FIXTURE DIRECTLY TOWARDS ANOTHER.

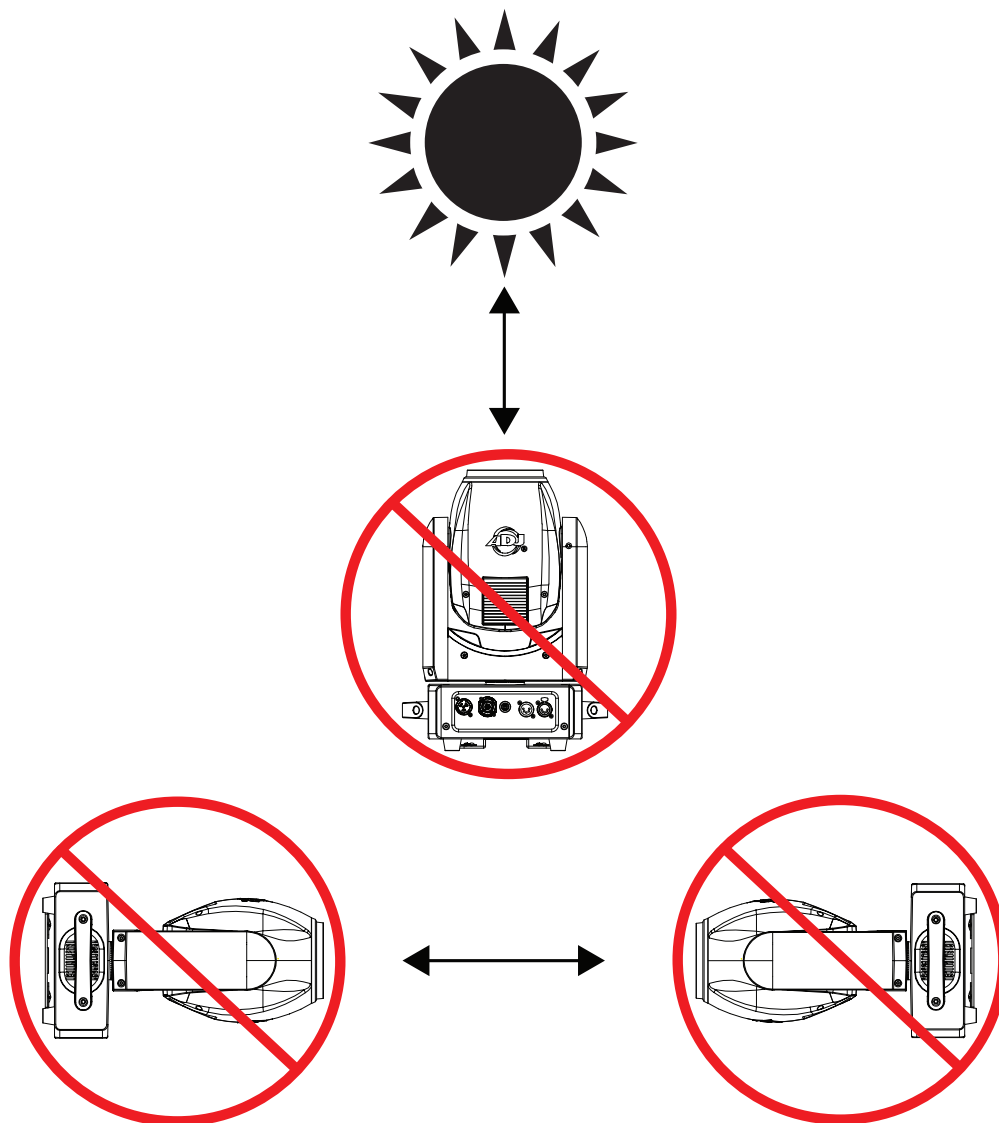

REMOTE DEVICE MANAGEMENT (RDM)

NOTE: In order for RDM to work properly, RDM enabled equipment must be used throughout the entire system, including DMX data splitters and wireless systems.

Remote Device Management (RDM) is a protocol that sits on top of the DMX512 data standard for lighting, allowing the DMX systems of the fixtures to be modified and monitored remotely. This protocol is ideal for instances in which a unit is installed in a location that is not easily accessible.

With RDM, the DMX512 system becomes bi-directional, allowing a compatible RDM enabled controller to send out a signal to devices on the wire, as well as allowing the fixture to respond (known as a *GET* command). The controller can then use its *SET* command to modify settings that would typically have to be changed or viewed directly via the unit's display screen, including the DMX Address, DMX Channel Mode, and Temperature Sensors.

FIXTURE RDM INFORMATION:

RDM Code	Device ID	Device Model ID	Personality ID
0x1900	Generated by MCU ID	0x0102	16Ch (1) 20Ch (2)

Please be aware that not all RDM devices support all RDM features, and therefore it is important to check beforehand to ensure that the equipment that you are considering includes all of the features that you require.

Disc Unique Branch [0x0001]	Manufact Label [0x0081]
Disc Mute [0x0002]	Device Label [0x0082]
Disc Un Mute [0x0003]	DMX Personality [0x00E0]
Supported Parameters [0x0050]	DMX Personality Description [0x00E1]
Parameter Description [0x0051]	Device Hours [0x0400]
Device Info [0x0060]	Lamp Hours [0x0401]
Software Version Label [0x00C0]	Lamp Strikes [0x0402]
DMX Start Address [0x00F0]	Pan Invert [0x0600]
Identify Device [0x1000]	Tilt Invert [0x0601]
Device Model Description [0x0080]	Pan Tilt Swap [0x0602]

CONTROL PANEL

This unit features a display screen with a 4-button control pad, which can be used to easily adjust any device settings.

Pressing the MODE button will cycle through the various Main Menu options. When the desired Main Menu option is displayed on the screen, press the ENTER button to enter the sub-menu, then use the UP, DOWN, LEFT, and RIGHT buttons to navigate through sub-menu options. In some cases, there will be a second sub-menu that can be navigated in the same way.



SYSTEM MENU

MAIN MENU		OPTIONS / VALUES		
DMX SETTINGS	Address	001 - 512		Set DMX starting address
	DMX CH Mode	16Ch / 20Ch		Select DMX channel mode
	No DMX Status	Hold Last		Unit holds last settings received if DMX signal is lost or interrupted
		Blackout		Unit takes all channels to 0 if DMX signal is lost or interrupted
		Manual		Unit defaults to pre-selected manual mode if DMX signal is lost or interrupted
PERSONALITY	Prim/Sec Mode	Primary / Secondary		Set unit as primary or secondary
	Select Signal	DMX or Aria / Aria and DMX Out		Select signal source
	Aria Settings	Aria Enable	On / Off	Enable or disable Aria
		Set Aria Channel	0 - 14	Select Aria channel
		Set Aria Band	2.4GHz/900MHz	Select wireless frequency
		Mesh	On / Off	Enable or disable mesh
		RDM	On / Off	Enable or disable RDM
		Bluetooth	On / Off	Enable or disable Bluetooth
		Repeater	On / Off	Enable or disable repeater
		Starting TTL	0 - 7	Set starting TTL
		Rsequence	000 - 255	Set R Sequence
		Repeater Count	000 - 255	Set repeater count
		Severity	On / Off	Enable or disable severity
		Sub-GHz Channel	0 - 9	Set sub-GHz channel
		Is Primary	On / Off	Set as Aria primary
	Status Settings	Pan Invert	On / Off	Enable or disable pan inversion
		Tilt Invert	On / Off	Enable or disable tilt inversion
		P/T Feedback	On / Off	Enable or disable pan/tilt feedback
		P/T Speed	Speed 1 Speed 2	Select pan/tilt movement speed
		Hibernation	Off, 01min - 99 min, default = 15min	The unit goes into standby mode after the selected period without DMX signal
	Reset Motors	Reset All Motors	Yes / No	Reset the selected motor(s)
		Pan/Tilt Reset	Yes / No	
		Color Reset	Yes / No	
		Gobo Reset	Yes / No	
		Frost Reset	Yes / No	
		Prism Reset	Yes / No	

SYSTEM MENU

MAIN MENU		OPTIONS / VALUES				
PERSONALITY (continued)	Display	Intensity	1 - 10	Adjust display brightness		
		Display Invert	Auto	Display automatically orients itself to remain upright		
			Yes	Inverted display orientation		
			No	Standard display orientation		
		Screen Saver Delay	Off - 10min	Screen goes into standby mode after selected period of inactivity		
	Service Passcode = 050	Effects Adjust	Pan -127 ~ 127	Effects adjustment. Note: Do NOT adjust while performing a factory reset at the same time.		
			Tilt -127 ~ 127			
			Color -127 ~ 127			
			...			
			Focus -127 ~ 127			
		Color Adjust	Color 1 -127 ~ 127	Color adjustment		
			Color 2 -127 ~ 127			
			...			
			Color15 -127 ~ 127			
		Factory Restore	Yes / No	Reset unit to factory default settings		
		MANUAL CONTROL	Pan	000 - 255		Manually configure each unit parameter
			Pan Fine	000 - 255		
Tilt	000 - 255					
Tilt Fine	000 - 255					
Color	000 - 255					
Gobo	000 - 255					
Prism	000 - 255					
Prism Rot	000 - 255					
...	...					
P/T Speed	000 - 255					
Special	000 - 255					

SYSTEM MENU

MAIN MENU	OPTIONS / VALUES			
LAMP CONTROL	Lamp On/Off	On / <i>Off</i>		Manual lamp on/off control
	Lamp On with Power	On / <i>Off</i>		Lamp automatically turns on when unit is powered on
	Lamp On via DMX	<i>On</i> / Off		Allows lamp on/off via DMX
	Lamp Off via DMX	<i>On</i> / Off		
INFORMATION	Fixture Life Time	Power On Time	xxxxxx Hours	Total lifetime hours fixture has been powered on
		P-On Time-R	xxxxxx Hours	Hours fixture has been powered on since last reset
		P-On Time Reset	Passcode = 050	Reset P-On Time-R value
	Total Lamp Time	Lamp On Time	xxxxxx Hours	Resets to 0 when lamp is replaced and reset
		Lamp On Time-R	xxxxxx Hours	
		Lamp On Time Reset	Passcode = 050	
	Fan Info (RPM)	Base Fan	xxxx	Base Fan Speed
		Lamp Fan	xxxx	Lamp Fan Speed
	DMX Values	Pan		Display current DMX value for selected parameter
		Pan Fine		
		Tilt		
		...		
		Special		
	Error Logs	Fixture Errors		Display fixture errors one by one
		Reset Error Log	Passcode = 050	Clear error log
	Software Ver- sion	Vx.xx		Display current software version

DMX SET UP

DMX-512: DMX is short for Digital Multiplex. This is a universal protocol used as a form of communication between intelligent fixtures and controllers. A DMX controller sends DMX data instructions from the controller to the fixture. DMX data is sent as serial data that travels from fixture to fixture via the DATA “IN” and DATA “OUT” XLR terminals located on all DMX fixtures (most controllers only have a DATA “OUT” terminal).

DMX Linking: DMX is a language allowing all makes and models of different manufacturers to be linked together and operate from a single controller, as long as all fixtures and the controller are DMX compliant. To ensure proper DMX data transmission, try to use the shortest cable path possible when linking several DMX fixtures. The order in which fixtures are connected in a DMX line does not influence the DMX addressing. For example, a fixture assigned a DMX address of 1 may be placed anywhere in a DMX line: at the beginning, at the end, or anywhere in the middle. When a fixture is assigned a DMX address of 1, the DMX controller knows to send DATA assigned to address 1 to that unit, no matter where it is located in the DMX chain.

Data Cable (DMX Cable) Requirements (For DMX Operation): This unit can be controlled via DMX-512 protocol. The DMX address is set on the rear panel of the unit. Your unit and your DMX controller require a standard 5-pin XLR connector for data input and data output. We recommend Accu-Cable DMX cables. If you are making your own cables, be sure to use standard 110-120 Ohm shielded cable (This cable may be purchased at almost all pro lighting stores). Your cables should be made with a male XLR connector at one end and a female XLR connector at the other. Also remember that DMX cable must be daisy chained and cannot be split.

Notice: Be sure to follow the illustration below when making your own cables. Do not use the ground lug on the XLR connector. Do not connect the cable’s shield conductor to the ground lug or allow the shield conductor to come in contact with the XLR’s outer casing. Grounding the shield could cause a short circuit and erratic behavior.

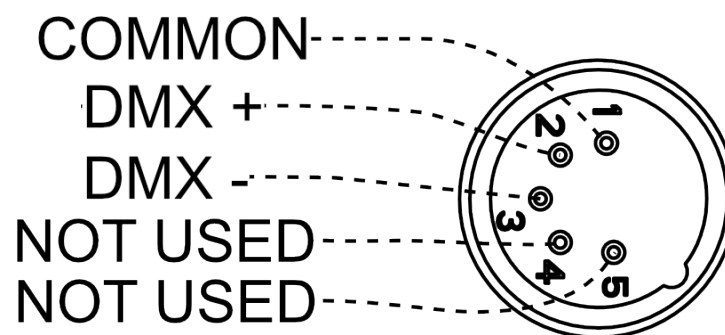

DMX SET UP

Special Note: Line Termination. When longer runs of cable are used, you may need to use a terminator on the last unit to avoid erratic behavior. A terminator is a 110-120 ohm 1/4 watt resistor which is connected between pins 2 and 3 of a male XLR connector (DATA + and DATA -). This unit is inserted in the female XLR connector of the last unit in your daisy chain to terminate the line. Using a cable terminator (ADJ part number Z-DMX/T) will reduce the risk of erratic behavior.

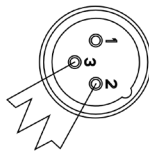
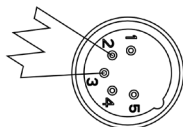

A DMX512 terminator reduces signal errors, avoiding most signal reflection interference. Connect PIN 2 (DMX-) and PIN 3 (DMX+) of the last fixture in series with a 120 Ohm, 1/4 W Resistor to terminate the DMX512.

DMX ADDRESSING.

All fixtures should be given a DMX starting address when using a DMX controller, so the correct fixture responds to the correct control signal. This digital starting address is the channel number from which the fixture starts to “listen” to the digital control signal sent out from the DMX controller. The assignment of this starting DMX address is achieved by setting the correct DMX address on the digital control display on the fixture.

You can set the same starting address for all fixtures or a group of fixtures, or set different addresses for each individual fixture. Setting all fixtures to the same DMX address will cause all fixtures to react in the same way. In other words, changing the settings of one channel will affect all the fixtures simultaneously.

If you set each fixture to a different DMX address, each unit will start to “listen” to the channel number you have set, based on the quantity of DMX channels of each fixture. That means changing the settings of one channel will only affect the selected fixture.

For example, when this unit is operating in 16 channel mode, you should set the starting DMX address of the first unit to 1, the second unit to 17 (1 + 16), the third unit to 33 (1 + 16 + 16), and so on. See the chart below for more details.

CHANNEL MODE	UNIT 1 ADDRESS	UNIT 2 ADDRESS	UNIT 3 ADDRESS	UNIT 4 ADDRESS
16Ch	1	17	33	49
20Ch	1	21	41	61

DMX TRAITS

CHANNEL		DMX VALUES	FUNCTION
16Ch	20Ch		
1	1		<i>Pan</i>
		000 - 255	Pan
2	2		<i>Pan Fine</i>
		000 - 255	Pan Fine
	3		<i>Tilt</i>
		000 - 255	Tilt
	4		<i>Tilt Fine</i>
		000 - 255	Tilt Fine
3	5		<i>Color</i>
		000 - 003	White
		004 - 007	Red
		008 - 011	Blue
		012 - 015	Green
		016 - 019	Lime
		020 - 023	Orange
		024 - 027	Pink
		028 - 031	Lavender
		032 - 035	Medium Red
		036 - 039	Aqua
		040 - 043	Amber
		044 - 047	CTB 9000K
		048 - 051	4500K
		052 - 055	CTO 3200K
		056 - 059	UV
		060 - 061	White
		062 - 063	White to Red
		064 - 065	Red
		066 - 067	Red to Blue
		068 - 069	Blue
		070 - 071	Blue to Green
		072 - 073	Green
		074 - 075	Green to Lime
		076 - 077	Lime
		078 - 079	Lime to Orange
		080 - 081	Orange
		082 - 083	Orange to Pink
		084 - 085	Pink

DMX TRAITS

CHANNEL		DMX VALUES	FUNCTION
16h	20Ch		
3	5		<i>Color (continued)</i>
		086 - 087	Pink to Lavender
		088 - 089	Lavender
		090 - 091	Lavender to Medium Red
		092 - 093	Medium Red
		094 - 095	Medium Red to Aqua
		096 - 097	Aqua
		098 - 099	Aqua to Amber
		100 - 101	Amber
		102 - 103	Amber to CTB 9000K
		104 - 106	CTB 9000K
		107 - 109	CTB 9000K to 4500K
		110 - 112	4500K
		113 - 115	4500K to CTO 3200K
		116 - 118	CTO 3200K
		119 - 121	CTO 3200K to UV
		122 - 124	UV
		125 - 127	UV to White
		128 - 189	Clockwise Rotation, fast to slow
		190 - 193	Stop
		194 - 255	Counter-Clockwise Rotation, slow to fast
4	6		<i>Static Gobo</i>
		000 - 014	Open
		015 - 017	Gobo 1
		018 - 020	Gobo 2
		021 - 023	Gobo 3
		024 - 026	Gobo 4
		027 - 029	Gobo 5
		030 - 032	Gobo 6
		033 - 035	Gobo 7
		036 - 038	Gobo 8
		039 - 041	Gobo 9
		042 - 044	Gobo 10
		045 - 047	Gobo 11
		048 - 050	Gobo 12
		051 - 053	Gobo 13
		054 - 056	Gobo 14

DMX TRAITS

CHANNEL		DMX VALUES	FUNCTION
16Ch	20Ch		
4	6		<i>Static Gobo (continued)</i>
		057 - 059	Gobo 15
		060 - 063	Open Shake, slow to fast
		064 - 067	Gobo 1 Shake, slow to fast
		068 - 071	Gobo 2 Shake, slow to fast
		072 - 075	Gobo 3 Shake, slow to fast
		076 - 079	Gobo 4 Shake, slow to fast
		080 - 083	Gobo 5 Shake, slow to fast
		084 - 087	Gobo 6 Shake, slow to fast
		088 - 091	Gobo 7 Shake, slow to fast
		092 - 095	Gobo 8 Shake, slow to fast
		096 - 099	Gobo 9 Shake, slow to fast
		100 - 103	Gobo 10 Shake, slow to fast
		104 - 107	Gobo 11 Shake, slow to fast
		108 - 111	Gobo 12 Shake, slow to fast
		112 - 115	Gobo 13 Shake, slow to fast
		116 - 119	Gobo 14 Shake, slow to fast
		120 - 127	Gobo 15 Shake, slow to fast
		128 - 189	Clockwise Rotation, fast to slow
		190 - 193	Stop
		194 - 255	Counter-Clockwise Rotation, slow to fast
5	7		<i>Prism</i>
		000 - 007	Prism 1 and Prism 2 Out
		008 - 127	Prism 1 In
		128 - 255	Prism 2 In
6	8		<i>Prism Rotation</i>
		000 - 127	0% ~ 100%
		128 - 189	Clockwise Rotation, fast to slow
		190 - 193	Stop
		194 - 255	Counter-Clockwise Rotation, slow to fast

DMX TRAITS

CHANNEL		DMX VALUES	FUNCTION
16Ch	20Ch		
7	9		<i>Shutter</i>
		000 - 031	Close
		032 - 063	Open
		064 - 095	Strobe, slow to fast
		096 - 127	Open
		128 - 159	Pulse Effect in sequence
		160 - 191	Open
		192 - 223	Random Strobe, slow to fast
		224 - 255	Open
8	10		<i>Dimmer</i>
		000 - 255	0% ~ 100%
	11		<i>Dimmer Fine</i>
		000 - 255	0% ~ 100%
9	12		<i>Focus</i>
		000 - 255	0% ~ 100%
	13		<i>Focus Fine</i>
		000 - 255	0% ~ 100%
10	14		<i>Frost</i>
		000 - 015	Off
		016 - 255	On
11	15		<i>Pan/Tilt Macros</i>
		000 - 007	Off
		008 - 015	Macro 1
		016 - 023	Macro 2
		024 - 031	Macro 3
		032 - 039	Macro 4
		040 - 047	Macro 5
		048 - 055	Macro 6
		056 - 063	Macro 7
		064 - 071	Macro 8
		072 - 079	Macro 9
		080 - 087	Macro 10
		088 - 095	Macro 11
		096 - 103	Macro 12
		104 - 111	Macro 13
		112 - 119	Macro 14
		120 - 127	Macro 15

DMX TRAITS

CHANNEL		DMX VALUES	FUNCTION
16Ch	20Ch		
11	15		<i>Pan/Tilt Macros (continued)</i>
		128 - 135	Macro 16
		136 - 143	Macro 17
		144 - 151	Macro 18
		152 - 159	Macro 19
		160 - 167	Macro 20
		168 - 175	Macro 21
		176 - 183	Macro 22
		184 - 191	Macro 23
		192 - 199	Macro 24
		200 - 207	Macro 25
		208 - 215	Macro 26
		216 - 223	Macro 27
		224 - 231	Macro 28
		232 - 239	Macro 29
		240 - 247	Macro 30
		248 - 255	Macro 31
12	16		<i>Pan/Tilt Macro Speed</i>
		000 - 255	Fast to Slow
13	17		<i>Color Time</i>
		000 - 255	Fast to Slow
14	18		<i>Gobo Time</i>
		000 - 255	Fast to Slow
15	19		<i>Pan/Tilt Speed</i>
		000 - 255	Fast to Slow
16	20		<i>Special Function</i>
		000 - 019	No Function
		020 - 029	Enable color wheel indexing - the color wheel shall move in increments of 1, allowing the user to set their desired color split between DMX values of 1 and 255
		030 - 039	Disable color wheel indexing
		040 - 059	Enable frost indexing - the frost filter shall move in increments of 1, allowing the user to produce a more linear frost effect between DMX values of 16 and 255
		060 - 069	Disable frost indexing
		070 - 079	Enable blackout while pan/tilt moving
		080 - 089	Disable blackout while pan/tilt moving

DMX TRAITS

CHANNEL		DMX VALUES	FUNCTION
16Ch	20Ch		
16	20		<i>Special Function (continued)</i>
		090 - 099	Enable blackout while color changing
		100 - 109	Disable blackout while color changing
		110 - 119	Enable blackout while gobo changing
		120 - 129	Disable blackout while gobo changing
		130 - 139	Lamp On
		140 - 149	Reset XY
		150 - 159	Reset Effect
		160 - 169	Reset Color
		170 - 199	No Function
		200 - 209	Reset All
		210 - 229	No Function
		230 - 239	Lamp Off
		240 - 255	No Function

PRIMARY-SECONDARY SET UP

This function allows you to link units together to run in a Primary-Secondary set-up, in which one unit will act as the controlling unit and the others will react to the controlling unit's built-in programs. Any unit can be configured to act as a Primary or as a Secondary, but only one unit in a given system can be programmed to act as the Primary.

Primary-Secondary Connections and Settings:

1. Daisy chain your units via the XLR connectors on the rear panels of each unit. Use standard XLR data cables to link your units together. Remember that the male XLR connector is the input and the female XLR connector is the output. The first unit in the chain (primary) will use the female XLR connector only. The last unit in the chain will use the male XLR connector only.
2. Use the display screen and control panel to navigate to Personality > Prim/Sec Mode. Select this sub-menu using the ENTER button, and use the UP and DOWN buttons to toggle between "Primary" and "Secondary". Press ENTER to confirm your selection.
3. Repeat Step 2 for each unit in the system. Make sure that only one unit is designated as the Primary, while all other units are designated as Secondaries.
4. The secondary units will now follow the behavior of the primary unit.

NOTES:

- Only one unit should be configured as the primary, while all the other units should be configured as secondaries.
- All units should be set to the same DMX channel mode.
- If fixtures fail to sync, verify that all settings mentioned above are the same, then power all devices off, then switch them on again to re-establish the link.

MULTI UNIT POWER LINKING

This feature allows you to connect the fixtures to one another using the power cable input and output sockets.

The maximum number of units that can be linked in this manner is as follows:

- 5 units @ 110V power
- 10 units @ 220V power

DO NOT EXCEED THIS MAXIMUM NUMBER WHEN POWER LINKING UNITS!

All linked units must be of the same make and model type. Do not mix and match units!

MAINTENANCE GUIDELINES



DISCONNECT POWER BEFORE PERFORMING ANY MAINTENANCE!

CLEANING

Frequent cleaning is recommended to ensure proper function, optimized light output, and an extended life. The frequency of cleaning depends on the environment in which the fixture operates: damp, smoky, or particularly dirty environments can cause greater accumulation of dirt on the fixture's optics. Clean the external lens surface regularly with a soft cloth to avoid dirt/debris accumulation.

NEVER use alcohol, solvents, or ammonia-based cleaners.

MAINTENANCE

Regular inspections are recommended to ensure proper function and extended life. There are no user serviceable parts inside this fixture. Please refer all other service issues to an authorized ADJ service technician. Should you need any spare parts, please order genuine parts from your local ADJ dealer.

Please refer to the following points during routine inspections:

- A. A detailed electrical check by an approved electrical engineer every three months, to make sure the circuit contacts are in good condition and prevent overheating.
- B. Be sure all screws and fasteners are securely tightened at all times. Loose screws may fall out during normal operation, resulting in damage or injury as larger parts could fall.
- C. Check for any deformations on the housing, color lenses, rigging hardware, and rigging points (ceiling, suspension, trussing). Deformations in the housing could allow for dust to enter into the fixture. Damaged rigging points or unsecured rigging could cause the fixture to fall and seriously injure a person(s).
- D. Electric power supply cables must not show any damage, material fatigue, or sediments.

NEVER remove the ground prong from the power cable.

ERROR CODES

ERROR GROUP	ERROR CODE	DESCRIPTION
Encoder Error	Pan Encoder Error	Encoder Error: Pan
	Tilt Encoder Error	Encoder Error: Tilt
Sensor Error	Pan Sensor Error	Sensor Error: Pan
	Tilt Sensor Error	Sensor Error: Tilt
	Color Sensor Error	Sensor Error: Color
	Gobo Sensor Error	Sensor Error: Gobo
	Prism Sensor Error	Sensor Error: Prism
	Prism Rot Sensor Error	Sensor Error: Prism Rotation
	Focus Sensor Error	Sensor Error: Focus
Communication Error	CPU-B Error	Lost Connection: Pan / Tilt
	CPU-C Error	Lost Connection: Effects
Fan Error	Base-Fan Error	Fan Error: Base-Fan
	Lamp-Fan Error	Fan Error: Lamp-Fan
Lamp Error	Lamp Communication Error	Lamp Error: Communication
	Lamp Ignite Failed Error	Lamp Error: Ignite Failed

Technical drawing of the T1000 1000W 10000lm LED Floodlight, showing multiple views and dimensions in inches and millimeters.

Top View Dimensions:

- Overall width: 9.6in (243.6mm)
- Overall height: 9.4in (239.6mm)
- Mounting bracket width: 3.8in (98mm)
- Mounting bracket height: 16.3in (416mm)

Front View Dimensions:

- Overall width: 12in (304mm)
- Overall height: 15.2in (388mm)
- Mounting bracket width: 8.8in (223mm)
- Mounting bracket height: 13.6in (346mm)
- Light head width: 6.7in (169.6mm)
- Light head height: 12in (305.6mm)
- Light head diameter: $\phi 3.9in$ ($\phi 100mm$)

Side View Dimensions:

- Overall width: 9in (230mm)
- Overall height: 9in (230mm)
- Mounting bracket width: 9in (230mm)
- Mounting bracket height: 3.4in (87.5mm)

Bottom View Dimensions:

- Overall width: 6.4in (164mm)
- Overall height: 6.4in (164mm)
- Mounting bracket width: 4.2in (107mm)
- Mounting bracket height: 4.2in (107mm)

Detail View Dimensions:

- Light head diameter: $\phi 10.9in$ ($\phi 277mm$)
- Mounting bracket width: 12.9in (327.8mm)
- Mounting bracket height: 2in (50.8mm)

SPECIFICATIONS

Light Source:

- OSRAM Sirius HRI 100W Discharge Lamp (6,000 hr.)
- Color temperature: 9000K (+/- 300K)

Features:

- On-Board Wireless DMX
- Motorized Focus + 16-bit fine focus
- 2-degree beam angle
- Frost Filter to create wash effect
- High quality glass lens
- 2 Rotating prisms:
- 0-100% smooth dimming
- Various strobe speeds
- OTA, wireless, firmware updates
- Fan cooled

Color Wheel:

- 14 dichroic colors + white (Includes CTO (3200K), CTO (4500K), CTB (9000k) & UV)
- Indexable color wheel for split colors

GOBO Wheel:

- 15 static GOBOs + open (3 GOBOs are beam reducers)
- GOBO Shake Effect

Prism Wheels:

- 2 Rotating prisms
- 16 facet circular and 4 facet linear prisms

Control:

- Protocols: DMX512 & RDM
- Control Mode: DMX512 & Manual (On-board Controls)
- 2 DMX Channel Modes: 16/20 Channels
- Color LCD display with 4-button function menu
- 0-100% smooth dimming
- Various strobe speeds
- With Wired Digital Communication Network

Pan/Tilt:

- Pan: 540 degrees (plus 16-bit fine pan)
- Tilt: 270 degrees (plus 16-bit fine tilt)
- 3 Phase, High Speed, Pan/Tilt motors

Connections:

- DMX Connections: 5-pin DMX In/Out (Data link max: 32 fixtures)
- Power Connections: Outdoor locking In/Out connections to daisy chain power

Electrical:

- Multi-voltage operation: 100-240V, 50/60Hz
- Max power consumption: 168W (@120V), 157W (@230V)
- Fuze Protected: 3.15A

Dimensions & Weight:

- Dimension: 9" (L) x 12" (W) x 16.3" (H) (230 x 304 x 416mm)
- Weight: 16.5 lbs. / 7.5 kg.

Approvals / Ratings

- CE
- cETLus (Pending)



Please Note: Specifications and improvements in the design of this unit and this manual are subject to change without any prior written notice.

